



Manual



**BAT.PAR 6 RGBUV**

---

## Table of contents

1. Safety instructions .....	3
1.1. For safe and efficient operation .....	3
2. Designated use .....	4
2.1. Overhead installation .....	5
3. Introduction .....	7
3.1. Product overview .....	7
3.2. Dimensions .....	7
4. Connections .....	8
4.1. DMX connections .....	8
4.2. DMX connection with terminator .....	8
5. Control .....	9
5.1. Structure of the menu .....	9
6. DMX chart .....	10
6.1. DMX Mode 1 (1 channel) .....	10
6.2. DMX Mode 2 (4 channels) .....	11
6.3. DMX Mode 3 (6 channels) .....	11
6.4. DMX Mode 4 (7 channels) .....	11
7. Battery .....	13
8. Remote .....	14
9. Technical data .....	15

## 1. Safety instructions



- This device is suitable for indoor use (not outdoors) only.
- All modifications to the device will void the warranty.
- Repairs are to carry out by skilled personnel only.
- Use only fuses of the same type and original parts as spare parts.
- Protect the unit from rain and humidity to avoid fire and electric shocks.
- Make sure to unplug the power supply before opening the housing.

### 1.1. For safe and efficient operation

#### **Be careful with heat and extreme temperature**

Avoid exposing it to direct rays of the sun or near a heating appliance.  
Not put it in a temperature below 32°F /0°C, or exceeding 104°F /40°C.

#### **Keep away from humidity, water and dust**

Do not place the set in a location with high humidity or lots of dust.  
Containers with water should not be placed on the set.

#### **To avoid placing on un-stable location**

Select a level and stable location to avoid vibration.

#### **Do not use chemicals or volatile liquids for cleaning**

Use a clean dry cloth to wipe off the dust, or a wet soft cloth for stubborn dirt.

#### **If out of work, contact sales agency immediately**

Any troubles arose, remove the power plug soon, and contact with an engineer for repairing, do not open the cabinet by yourself, it might result a danger of electric shock.

#### **Take care with the power cable**

Never pull the power cable to remove the plug from the receptacle, be sure to hold the plug. When not using the device for an extended period of time, be sure to disconnect the plug from the receptacle.

#### **Important:**

**Damages caused by the disregard of this user manual are not subject to warranty. The dealer will not accept liability for any resulting defects or problems. Make sure the electrical connection is carried out by qualified personnel. All electrical and mechanical connections have to be carried out according to the European safety standards.**

## 2. Designated use

This device was developed for professional use on stages, in discos, theatres etc. The device is only approved for a connection up to 230V 50/60 Hz AC voltage and only for indoor use.

Regular breaks during operation increase the lifetime of your device.

Avoid convulsions or any form of forceful impact during the installation or the start-up of the device.

Make sure that the device is not exposed excessive heat, humidity or dust at the place of installation. Take care that no cables are lying around. You would endanger your own safety and also the safety of a third party.

It is not allowed to operate or store the device in an environment in which spray water, rain, humidity or fog is expected. Humidity or very high atmospheric humidity could reduce the isolation of the device and could cause deathly electric shocks. If you use fog devices the device has not be exposed to a direct smoke jet. There has to be a safety distance of at least 0,5m between this device and the fog machine. Make sure that the saturation of the fog has to enable a visibility of at least 10m.

Operate the device not during thunderstorms. Surge voltages could destroy the device. Unplug the power supply during thunderstorms.

During the installation the use of the mounting bracket is obligatory.

Surrounding objects or surfaces should not be in contact with the device. And make sure that there is a distance of at least 0.2m between the lenses and illuminated objects.

Make sure that during the installation and removal of the device the area below the place of installation is basically cordoned off. This also applies to implementation of service.

The device has basically been protected by a suitable safety.

Make familiar yourself with the functions of the device before start-up. People without the experience should not handle with the device. The most cause of functional disorder is inappropriate handling.

Do not use chemicals or volatile liquids for cleaning. Use a clean dry cloth to wipe off the dust, or a wet soft cloth for stubborn dirt.

For transport use the original packing or designated accessory to avoid damages during the transport.

### **For reasons of safety unauthorized changes are forbidden.**

A usage of the device which differs from usages which are described in this manual can cause damages of the device. In that case the warranty expires. Additional you should notice that every differed usage is related with dangers and can cause e.g. an electrical short, fire, electric shock or crash.

## 2.1. Overhead installation



### **Danger of life!**

**You have to observe the regulations of BGV C1 (formerly VBG 70) and EN60598-2-17 Installations are to carry out by skilled personnel only.**

The suspension devices have to be build and measured so they can withstand for an hour the tenfold of the payload without suffering a permanent detrimental deformation.

Basically installation has to be made by using a second separate suspension. This can be e.g. a suitable net. The second suspension must be designed and attached so no part of the installation can fall down in case of failure.

During construction, reconstruction and deconstruction unnecessary stay in the range of moving areas, on lightning bridges, under elevated work stations or any other danger zones is forbidden.

The operator is obliged to following safety-related and mechanical facilities:

- Before the first start-up or after critical changes before restarting it has to be checked by an expert.
- Review in the frame of the inspection test at least all four years by an expert. .
- Review by a qualified person at least once a year.

### **How to carry out the overhead installation:**

In tidal fall you should install the device out of the lounge area of people

**IMPORTANT!** Overhead installation requires a high level of experience. This includes knowledge of calculating the payload, used installation material and safety inspections of the used material and the projector whereas the required experience is not limited to this. Do not try to carry out installation yourself under any circumstances if you are not qualified. Contact a professional installer. An inappropriate installation can lead to injuries and/or damaged properties.

It is not allowed to install the device in the grip area of people.

If the device may hang from the ceiling or from high beams, the use of truss systems is mandatory. The device may not be installed so it can swing freely in the room.

Please note: Crashing down items can cause serious injuries! Do not install the projector, if you doubt the safety of a possible installation form!

Before installation make sure that the mounting surface has the ability to carry the tenfold point load of the own weight of the device.

Mount the device with the mounting-bracket to your trussing system using an appropriate clamp.

During overhead installation the device must be always secured by a safety rope which is designed to hold the twelvefold weight of device. Only safety ropes with quick-release safety fastener elements may be used. Hang up the safety rope in the hole of the mounting bracket. Direct the rope over the truss or an appropriate fastening point. Hang up the end in the fastening element and tie up the locking nut. A safety rope once exposed to failing load or damaged may not be used furthermore.

**The maximum drop exceed must not exceed 20cm.**

A safety rope once exposed to failing load or damaged may not be used furthermore.  
Adjust the desired inclination angle via the mounting bracket and tighten the screw.

### 3. Introduction

Thank you for buying the **BAT.PAR 6 RGBUV**. It is a powerful device.  
For a successful installation and operation, please read this manual carefully.

#### 3.1. Product overview

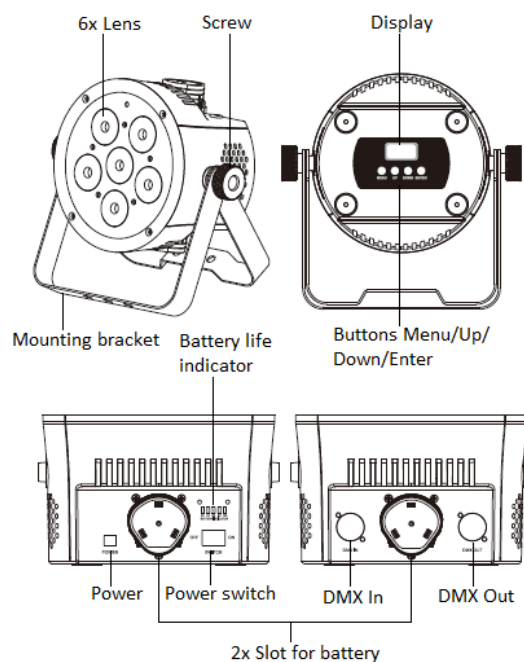

#### 3.2. Dimensions

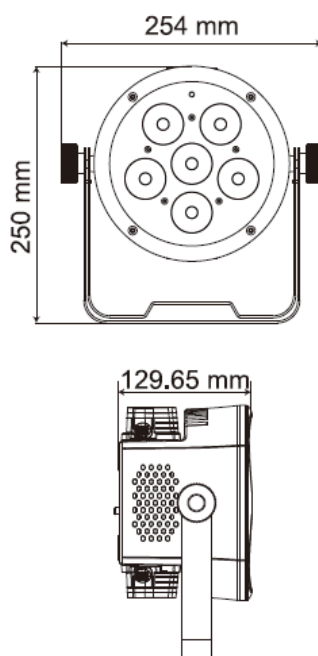

## 4. Connections

### 4.1. DMX connections

To make a DMX512 connection go ahead like it is described in the picture. Make sure that you use shielded cable. 3pole or 5pole XLR cables are suitable.

Important! After the last device the line has to be terminated. In order to do this you have to solder a 120 $\Omega$  resistor between the pins Data + and Data -. You can solder this end resistor on a 3pin or 5pin XLR: Plug this adapter into the DMX output of the device.

### 4.2. DMX connection with terminator

Where the DMX cable has to run a long distance or the equipment is operated in an electrically noisy environment like a disco for installations, we recommend using a DMX terminator. This prevents corruption of the digital control signal by electrical noise. The DMX terminator is simply an XLR connector with a 120  $\Omega$  resistor between pins 2 and 3, which is then plugged into the XLR output socket of the last device in the series. Please look to the bottom drawings.

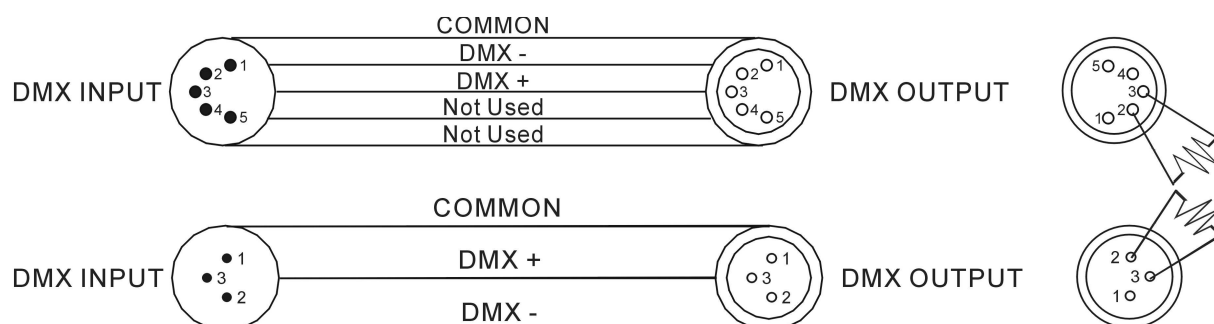



## 5. Control

Press MENU, to get to the menu. With UP/DOWN you can choose the required submenu. Confirm with ENTER. With UP/DOWN you can make the required settings. Confirm with ENTER. By pressing MENU you can step back to the main menu. .

### 5.1. Structure of the menu

Menu	Submenu 1	Submenu 2	Function
Addr	A001 – A512		Setting the DMX address.
SoUn	SoU1 – SoU2	Se0 – Se9	Choosing a Sound-to-Light program and setting the sensitivity of the microphone.
Stat	r000 - r255		Dimmer red 0 – 100%
	g000 – g255		Dimmer green 0 – 100%
	b000 – b255		Dimmer blue 0 – 100%
	u000 – u255		Dimmer white 0 – 100%
	St00 – St20		Strobe slow – fast
CoLo	Co01 – Co51		Choosing a preset color.
Auto	Aut1 – Aut3	SP1 – SP9	Choosing an automatic program and setting the speed.
info	tenP		Sows the current temperature.
	uer		Shows the current software version.
reno	On/Off		(De-)Activates the remote.
Slave	Slave		Activates the Master-Slave mode.
Chnd	1ch		Choosing a DMX mode.
	4ch		
	6ch		
	7ch		

## 6. DMX chart

### 6.1.DMX Mode 1 (1 channel)

Channel	Value from	Value to	Function
1	0	4	No function
	5	9	Color 1
	10	14	Color 2
	15	19	Color 3
	20	24	Color 4
	25	29	Color 5
	30	34	Color 6
	35	39	Color 7
	40	44	Color 8
	45	49	Color 9
	50	54	Color 10
	55	59	Color 11
	60	64	Color 12
	65	69	Color 13
	70	74	Color 14
	75	79	Color 15
	80	84	Color 16
	85	89	Color 17
	90	94	Color 18
	95	99	Color 19
	100	104	Color 20
	105	109	Color 21
	110	114	Color 22
	115	119	Color 23
	120	124	Color 24
	125	129	Color 25
	130	134	Color 26
	135	139	Color 27
	140	144	Color 28
	145	149	Color 29
	150	154	Color 30
	155	159	Color 31
	160	164	Color 32
	165	169	Color 33
	170	174	Color 34
	175	179	Color 35
	180	184	Color 36
	185	189	Color 37
	190	194	Color 38
	195	199	Color 39
	200	204	Color 40

	205	209	Color 41
	210	214	Color 42
	215	219	Color 43
	220	224	Color 44
	225	229	Color 45
	230	234	Color 46
	235	239	Color 47
	240	244	Color 48
	245	249	Color 49
	250	254	Color 50
	255		Color 51

## 6.2. DMX Mode 2 (4 channels)

Channel	Value from	Value to	Function
1	0	255	Dimmer red 0 – 100%
2	0	255	Dimmer green 0 – 100%
3	0	255	Dimmer blue 0 – 100%
4	0	255	Dimmer white 0 – 100%

## 6.3. DMX Mode 3 (6 channels)

Channel	Value from	Value to	Function
1	0	255	Dimmer 0 – 100%
2	0	255	Dimmer red 0 – 100%
3	0	255	Dimmer green 0 – 100%
4	0	255	Dimmer blue 0 – 100%
5	0	255	Dimmer white 0 – 100%
6	0	255	Strobe slow – fast

## 6.4. DMX Mode 4 (7 channels)

Channel	Value from	Value to	Function
1	0	255	Dimmer 0 – 100%
2	0	255	Dimmer red 0 – 100%
3	0	255	Dimmer green 0 – 100%
4	0	255	Dimmer blue 0 – 100%
5	0	255	Dimmer white 0 – 100%
6	0	15	No function
	16	31	Automatic program1
	32	47	Automatic program2
	48	63	Automatic program3
	64	79	Automatic program4
	80	95	Automatic program5
	96	111	Automatic program6
	112	127	Automatic program7
	128	143	Automatic program8
	144	159	Automatic program9

	160	175	Automatic program10
	176	191	Automatic program11
	192	207	Automatic program12
	208	223	Automatic program13
	224	239	Sound-to-Light Mode 1
	240	255	Sound-to-Light Mode 2
7	0	255	<p>Setting the speed for channel 6 and the values 16 – 223.</p> <p>Setting the sensitivity of the microphone for channel 6 and the values 224 – 255.</p> <p>Strobe slow – fast, if channel 6 is deactivated.</p>

## 7. Battery

1. On the upside of the device is a battery life indicator. .

	Full charge
	80% charge
	60% charge
	40% charge
	20% charge
	No charge

2. You can use the device while charging.
  - Please insert the batteries to the slots (it is possible to charge 2 batteries at the same time) and do not remove them before the charging is finished.
  - Connect the charge adapter to the light and the charging starts. The 5 green indicators will keep running from left to right during charging. .
  - When the green indicators keep lightnng charging is finished.
  - During charging process the light can be turned off with the switch.

### **WARNING!**

Before using the battery, please read the battery manual first. If five indicators flash together, it is a warning that the charging system is broken. Please change the battery first. If it is still not working contact your sales agency to repair the device.

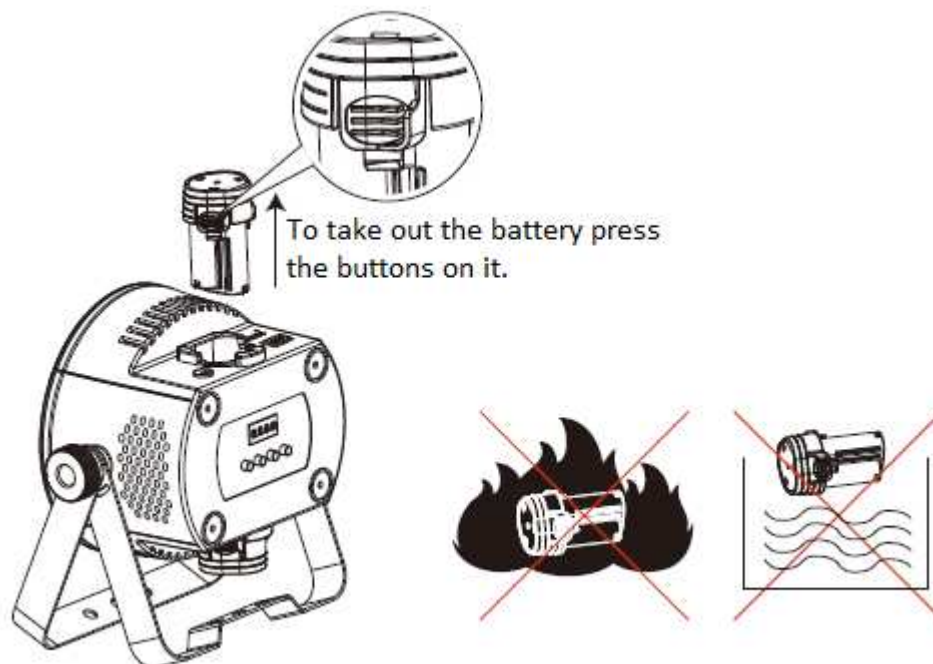

## 8. Remote



Power switch



Setting the DMX address by pressing the button.  
Double lclick you can set the channel mode.



Activates the Master-Slave mode.



Choosing an automatic program.



Setting the speed.



Choosing a Sound-to-Light mode.



Choosing a program or a numerical.



Strobe



Choosing a numerical in any program mode.



Choosing a color

## 9. Technical data

<b>Power supply</b>	
Voltage	100 – 240 V / 50-60 Hz with power adapter
Power consumption max.	48 W
Battery	Yes
<b>Light source</b>	
LM type	LED 4in1
Color spectrum	RGBUV
Power	48 W
Number / Power	6 x 8W
<b>Optics</b>	
Beam angle	25°
<b>Connections</b>	
Strom in	Input for power supply unit
XLR in/out	3pol
<b>Controlling</b>	
Sound-to-Light	Yes
Automatic	Yes
Master-Slave	Yes
DMX512	Yes
Number of channels	1 / 4 / 6 / 7 channels
<b>Hardware</b>	
Protection class	IP20
Suitability	Indoor
Dimensions (L/B/H)	250 x 254 x 129,65 mm
Weight	1,9 kg

**Importer:**

**B & K Braun GmbH**  
**Industriestraße 2**  
**D-76307 Karlsbad**  
[www.bkbraun.com](http://www.bkbraun.com)  
[info@bkbraun.com](mailto:info@bkbraun.com)

